

# AE 2000 Series

Heavy Duty – End Of Shaft

TECHNOLOGY · INNOVATION · QUALITY · VALUE

The AE 2000 series of Rotech shaft mounted motion sensors & encoders are manufactured in an extremely tough and durable aluminium casting with an industrial powder coated finish.

Installation is simple and easy, just one 12mm threaded hole in the end of the shaft being monitored or fitted using the unique “Mag-Con” magnetic connector.

A wide range of number of pulses per revolution are available together with AC and DC electrical outputs.



### FOR MONITORING:

- Speed
- Distance
- Direction
- Belt slip
- Shaft stopped
- Underspeed
- Overspeed
- Safety guards interlocking

### FEATURES:

- Totally self contained (no guards required)
- Maintenance free for maximum reliability
- 1 to 1000 pulses per revolution
- Environment ingress-IP67
- -25 to +70, 100, 125, 150, deg Celsius versions Available



### MAG-CON

Magnetic connector

For quick and easy installation of Rotech shaft mounted sensors & encoders

**IMPORTANT NOTE:**

**MAXIMUM OPERATING SPEED IS 300RPM**

**RECOMMENDED MINIMUM**

**SHAFT DIAMETER FOR FITTING=35MM**

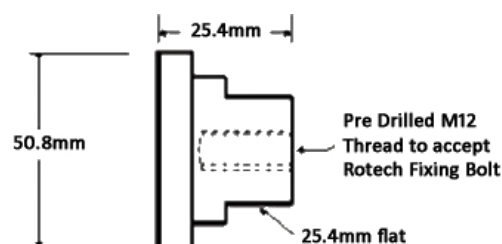

# Dimensions and Installation Information

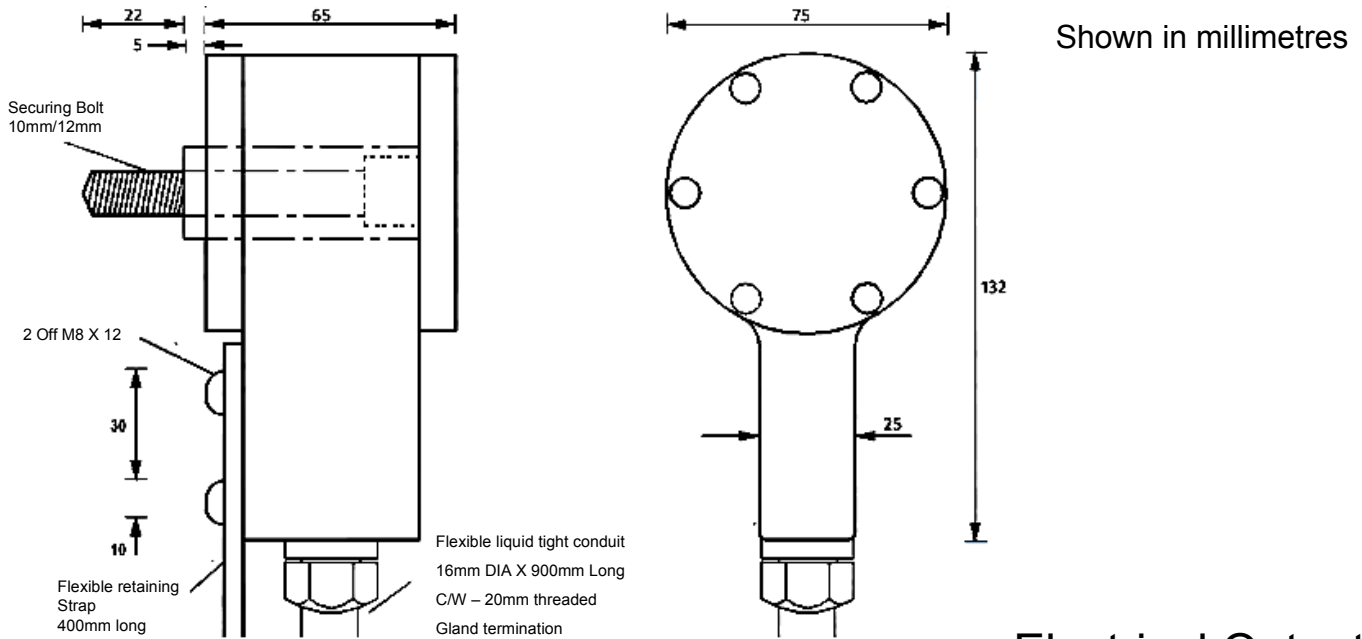

## Electrical Outputs

### Available Pulse Rates (PPR)

1,2,4,5,6,8,10,12,16,20,30,32,40,50,60,100,120,180,240,250,300,360,500,1000 (Dependent Upon Output Type)

<p>Type E (N.P.N) 10-30Vdc</p> <p>Max frequency = 600Hz</p>	<p>Type E2 (P.N.P) 10-30Vdc</p> <p>Max frequency = 600Hz</p>	<p>Type E3 (N.P.N/P.N.P 3 Wire) 10-30Vdc</p> <p>Max frequency = 1000Hz</p>
<p>Type E4 (N.P.N + P.N.P.- 2 Wire) 10-30Vdc</p> <p>Max frequency = 1300Hz</p>	<p>Type W 20-240V AC/DC (1 to 30 PPR only)</p> <p>Max frequency = 25Hz (AC) 1000Hz (DC)</p>	<p>Type N (Namur) 8-2 Vdc (1KΩ) Intrinsically safe circuits</p> <p>Max frequency = 2000Hz</p>
<p>Type E3 Q (Quadrature) 10-30Vdc</p> <p>CH "A" Leads CH "B" for clockwise rotation viewed from shaft end of encoder</p> <p>Channel "A"</p> <p>Channel "B"</p>		<p>Type E, E2 Q (Quadrature) 1 to 40 PPR inclusive</p> <p>Max frequency = 600Hz</p>